

92-ZM

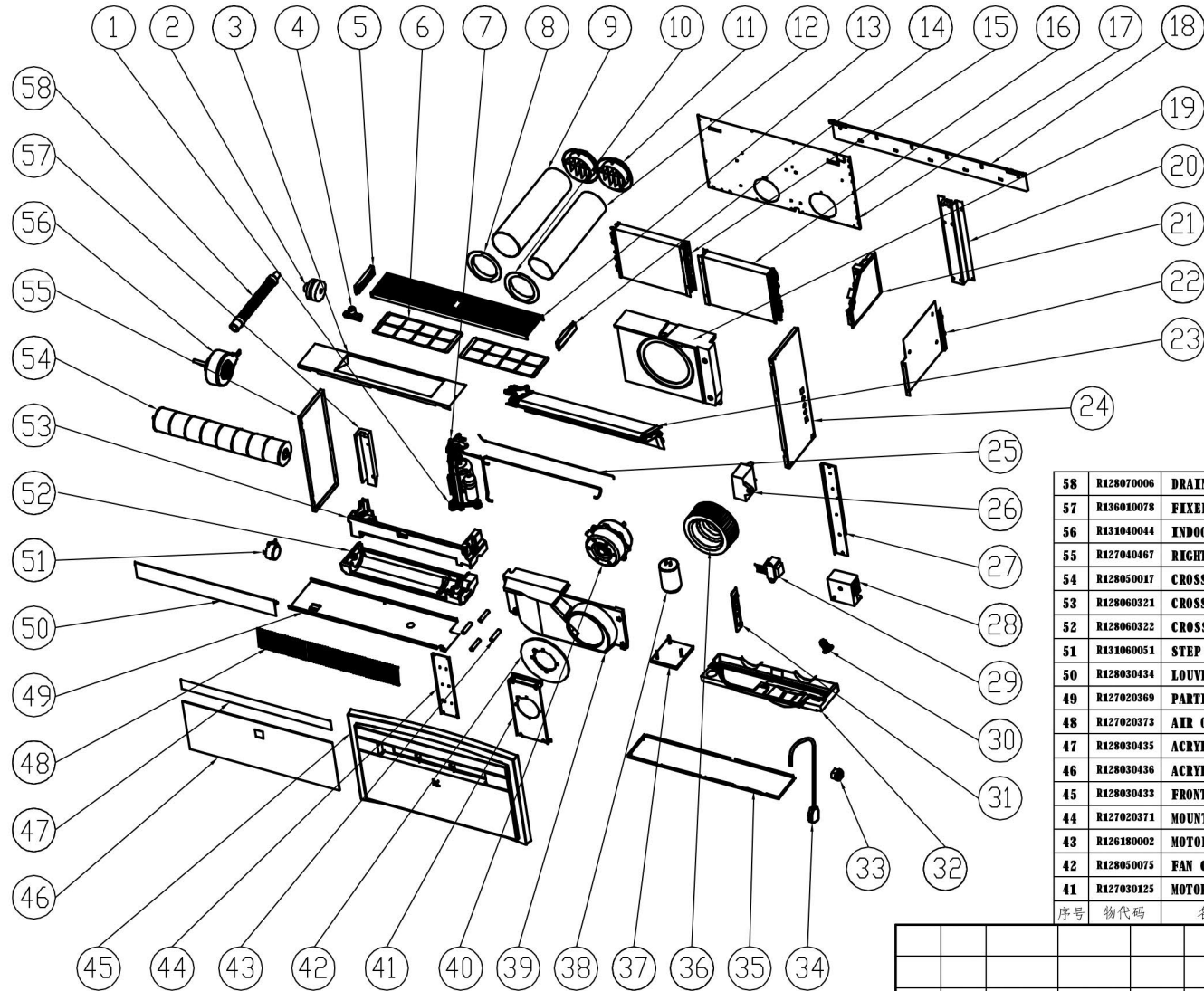

58	R128070006	DRAIN PIPE
57	R136010078	FIXED FOAM FOR CONDENSER
56	R131040044	INDOOR UNIT MOTOR
55	R127040467	RIGHT COVER
54	R128050017	CROSS FAN
53	R128060321	CROSS FAN COVER
52	R128060322	CROSS FAN BASE
51	R131060051	STEP MOTOR
50	R128030434	LOUVER
49	R127020369	PARTITION
48	R127020373	AIR OUTLET GRILLE
47	R128030435	ACRYLIC PANEL(UP)
46	R128030436	ACRYLIC PANEL(DOWN)
45	R128030433	FRONT PANEL
44	R127020371	MOUNTING SHEET
43	R126180002	MOTOR BOLT
42	R128050075	FAN COVER
41	R127030425	MOTOR BRACKET

40	R131030054	COMPRESSOR FAN MOTOR
39	R128060318	FAN HOUSING
38	R131160007	CAPACITOR FOR COMPRESSOR
37	R122160243	COMPRESSOR MOUNTING SHEET
36	R128050057	EXIAL FAN
35	R140150011	BASIC PAN
34	R132040139	POWER CABLE
33	R139010035	CABLE PLASTIC RING
32	R128060319	CONDENSER BASE
31	R128060314	FRESH AIR ADJUSTOR
30	R139010076	STOPPLE
29	R131110024	TRANSFORMER
28	R131030006	TERMINAL BLOCK
27	R127030127	ELECTRICAL MOUNTING SHEET
26	R131140014	CAPACITOR FOR MOTOR
25	R122060126	CAPILLARY
24	R128060312	LEFT COVER
23	R122010167	EVAPORATOR
22	R127030123	FIXTURE FOR PCB
21	R131010417	PCB
20	R127040463	LINK FOR CONDENSER
19	R128060320	AIR INLET FOR CONDENSER
18	R127080045	MOUNTING SHEET
17	R127020365	BACK COVER
16	R122050294	CONDENSER NEAR INTLET
15	R122050293	CONDENSER NEAR OUTLET
14	R128060316	RIGHT HANDLE
13	R127040469	AIR INLET GRILLE
12	R128060317	AIR INLET PIPE
11	R128030437	GRILLE
10	R128060310	O-RING FOR AIR OUTLET PIPE A
9	R128060318	AIR OUTLET PIPE
8	R128060311	O-RING FOR AIR OUTLET PIPE B
7	R122120239	REVERSING VALVE AND TUBES ASSY
6	R128020435	FILTER
5	R128060315	LEFT HANDLE
4	R128060317	CLASP FOR FILTER
3	R127020367	TOP COVER
2	R139050004	BEARING
1	R122110248	COMPRESSOR ASSY

借(通用)件登记

物代码

旧底图总号

底图总号

签字

日期



Clim WINDO Solo 2

标记处数						分区			更改文件号			签名			年月日			阶段标记			重量			比例		
设计						标准化												s								
校对																										
审核																										
工艺									批准												共 1 张			第 1 张		

中山深宝
电器制造有限公司

穿墙挂壁机
爆炸图

WZ-25